



## SOMA FEEL IN NORTH WATER FRONT LOCATION

### DESCRIPTION

- Convenient North Water Front location
- Creative tech space
- Close proximity to all forms of transportation nearby

### AVAILABLE SPACE & LEASE RATES

FIRST FLOOR	±1,700 – 4,100 SF	\$24/SF/YR/IG
SECOND FLOOR	±4,732 SF	\$28/SF/YR/IG
THIRD FLOOR	±4,712 SF	\$28/SF/YR/IG
<del>FOURTH FLOOR</del>	<del>±4,672 SF</del>	<del>\$28/SF/YR/IG</del>

Fourth Floor leased to Holt University

FOR MORE INFORMATION, PLEASE CONTACT

**MARA AABERG** | 415.477.8471 | [mara@starboardnet.com](mailto:mara@starboardnet.com)  
LIC #01887597

**HANS HANSSON** | 415.765.6897 | [hans@starboardnet.com](mailto:hans@starboardnet.com)  
LIC #00872902

**CRAIG HANSSON** | 415.694.5367 | [craig@starboardnet.com](mailto:craig@starboardnet.com)  
LIC #01841643



**STARBOARD TCN**  
WORLDWIDE COMMERCIAL REAL ESTATE  
*Local Focus, Global Reach*

33 New Montgomery, Suite 1230  
San Francisco, CA 94105  
phone 415.765.6900 fax 415.956.2003  
[www.starboardnet.com](http://www.starboardnet.com)

FIRST FLOOR:  
±1,700 - 4,100 SQ FT

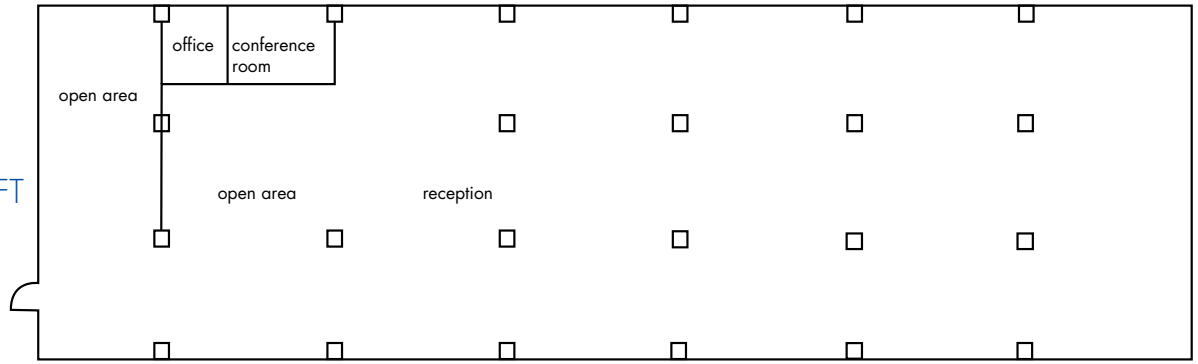

SECOND FLOOR:  
±4,732 SQ FT

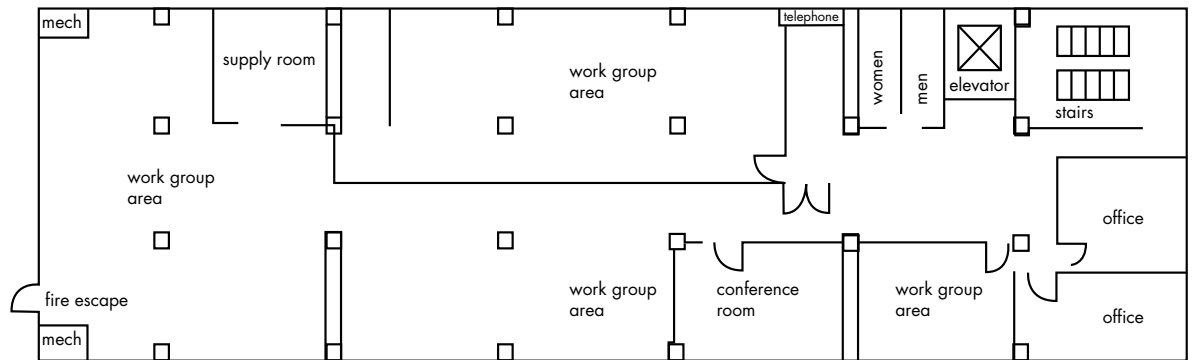

THIRD FLOOR:  
±4,712 SQ FT

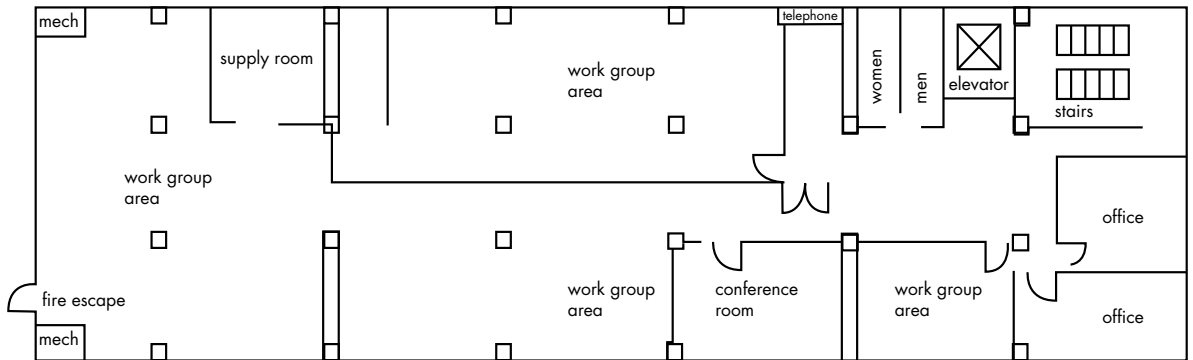

~~FOURTH FLOOR:~~  
~~±4,672 SQ FT~~  
**LEASED!**

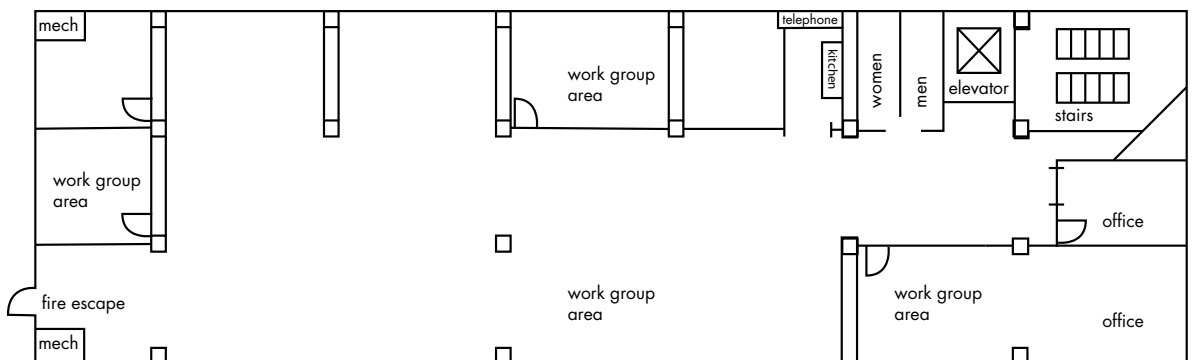

FOR MORE INFORMATION, PLEASE CONTACT

**MARA ABERG | 415.477.8471 | mara@starboardnet.com**  
LIC #01887597

**HANS HANSSON | 415.765.6897 | hans@starboardnet.com**  
LIC #00872902

**CRAIG HANSSON | 415.694.5367 | craig@starboardnet.com**  
LIC #01841643

**STARBOARD TCN**  
WORLDWIDE COMMERCIAL REAL ESTATE  
*Local Focus, Global Reach*

33 New Montgomery, Suite 1230  
San Francisco, CA 94105  
phone 415.765.6900 fax 415.956.2003  
www.starboardnet.com

