



HARD TO FIND CLASSIC TIMBER BUILDING IN SOMA—FOR LEASE

DESCRIPTION

centrally located, near Brainwash & the rest of Folsom Street

exposed brick fronts

exposed brick & timber interior

large conference room, entry way, 2 private offices, open area w/ skylights

can be used as live/work

high ceilings

SPACE AVAILABLE

±3,600 SQ FT

LEASE

\$1.30/SQ FT

FOR MORE INFORMATION, PLEASE CONTACT

HANS HANSSON | 415.765.6897 | hans@starboardnet.com
LIC #00872902

CRAIG HANSSON | 415.694.5367 | craig@starboardnet.com
LIC #01841643

 **STARBOARD TCN**
WORLDWIDE COMMERCIAL REAL ESTATE
Local Focus, Global Reach

33 New Montgomery, Suite 1230
San Francisco, CA 94105
phone 415.765.6900 fax 415.956.2003
www.starboardnet.com

FIRST FLOOR

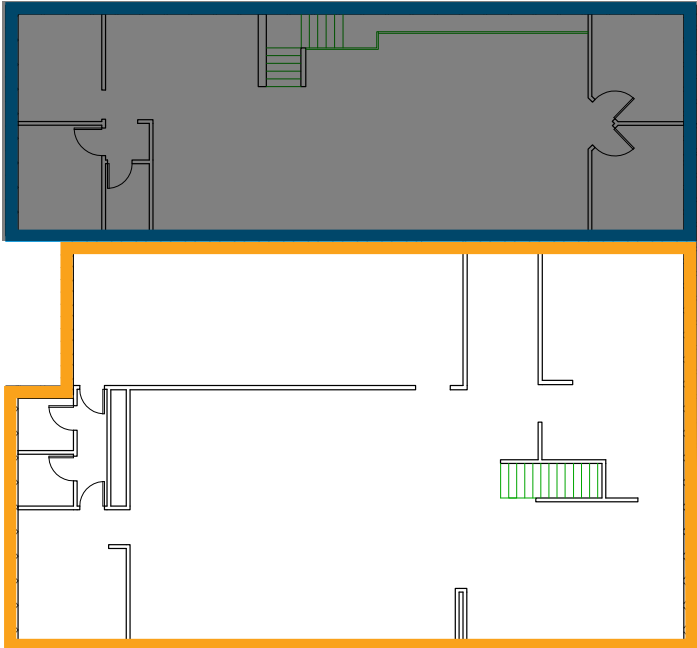

SECOND FLOOR

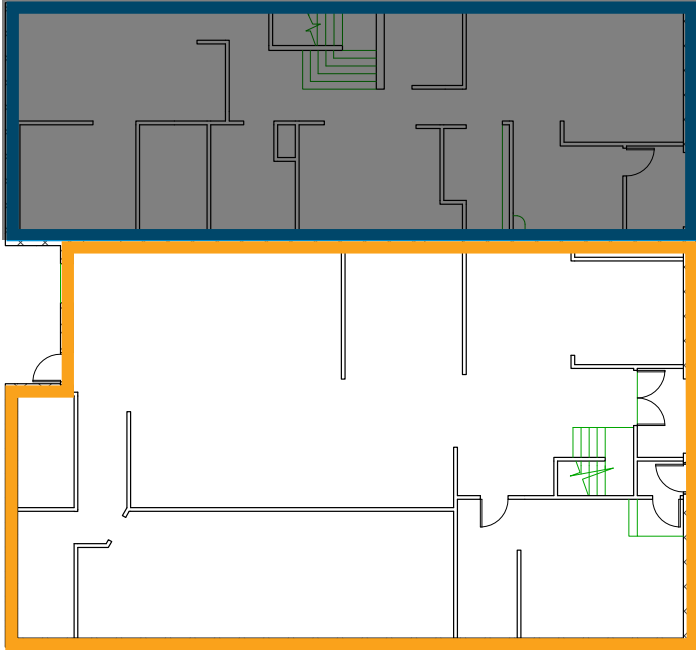

FOR MORE INFORMATION, PLEASE CONTACT

STARBOARD TCN
WORLDWIDE COMMERCIAL REAL ESTATE
Local Focus, Global Reach

33 New Montgomery, Suite 1230
San Francisco, CA 94105
phone 415.765.6900 fax 415.956.2003
www.starboardnet.com

HANS HANSSON | 415.765.6897 | hans@starboardnet.com
LIC #00872902

CRAIG HANSSON | 415.694.5367 | craig@starboardnet.com
LIC #01841643