



## HARD TO FIND CLASSIC TIMBER BUILDING IN SOMA—FOR SALE

### DESCRIPTION

centrally located, near Brainwash & the rest of Folsom Street  
exposed brick fronts  
exposed brick & timber interior  
large conference room, entry way, 2 private offices, open area w/ skylights  
can be used as live/work  
high ceilings

### SPACE AVAILABLE

±3,600 SQ FT

**OWN**

3,600 SQ FT x \$270/FT = **\$972,000**

FOR MORE INFORMATION, PLEASE CONTACT

**HANS HANSSON | 415.765.6897 | [hans@starboardnet.com](mailto:hans@starboardnet.com)**  
LIC #00872902

**CRAIG HANSSON | 415.694.5367 | [craig@starboardnet.com](mailto:craig@starboardnet.com)**  
LIC #01841643

**STARBOARD TCN**  
WORLDWIDE COMMERCIAL REAL ESTATE  
*Local Focus, Global Reach*

33 New Montgomery, Suite 1230  
San Francisco, CA 94105  
phone 415.765.6900 fax 415.956.2003  
[www.starboardnet.com](http://www.starboardnet.com)

## FIRST FLOOR

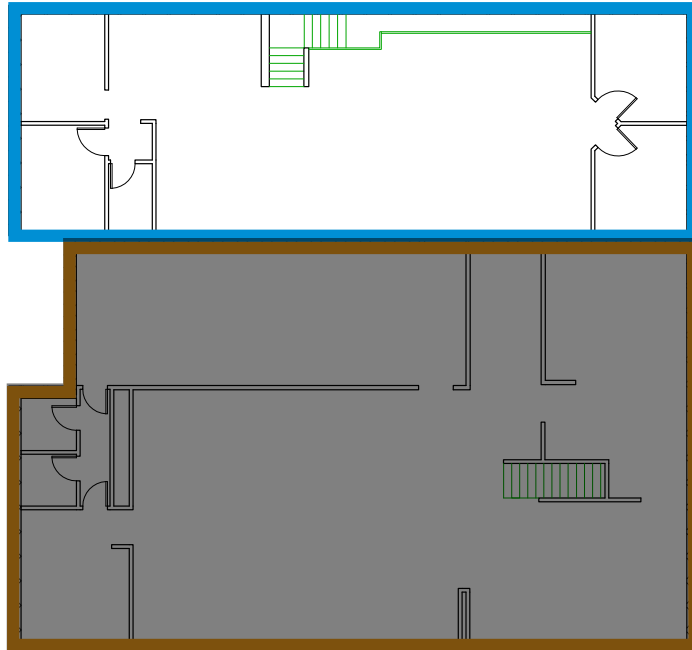

## SECOND FLOOR

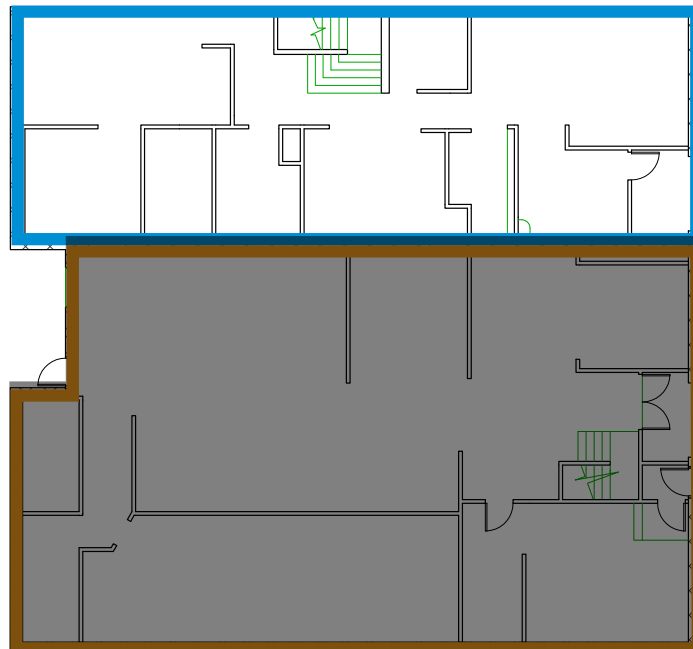

FOR MORE INFORMATION, PLEASE CONTACT

**HANS HANSSON | 415.765.6897 | [hans@starboardnet.com](mailto:hans@starboardnet.com)**  
LIC #00872902

**CRAIG HANSSON | 415.694.5367 | [craig@starboardnet.com](mailto:craig@starboardnet.com)**  
LIC #01841643

 **STARBOARD TCN**  
WORLDWIDE COMMERCIAL REAL ESTATE  
*Local Focus, Global Reach*

33 New Montgomery, Suite 1230  
San Francisco, CA 94105  
phone 415.765.6900 fax 415.956.2003  
[www.starboardnet.com](http://www.starboardnet.com)