

HARD TO FIND CLASSIC TIMBER BUILDING IN SOMA—FOR LEASE

DESCRIPTION

centrally located, near Brainwash & the rest of Folsom Street
2 floors, multiple skylights
exposed brick & timber interior
good power, office production ideal use
can be used as live/work
high ceilings

SPACE AVAILABLE

±6,300 SQ FT

LEASE

\$1.00/SQ FT

FOR MORE INFORMATION, PLEASE CONTACT

HANS HANSSON | 415.765.6897 | hans@starboardnet.com
LIC #00872902

CRAIG HANSSON | 415.694.5367 | craig@starboardnet.com
LIC #01841643

STARBOARD TCN
WORLDWIDE COMMERCIAL REAL ESTATE
Local Focus, Global Reach

33 New Montgomery, Suite 1230
San Francisco, CA 94105
phone 415.765.6900 fax 415.956.2003
www.starboardnet.com

FIRST FLOOR

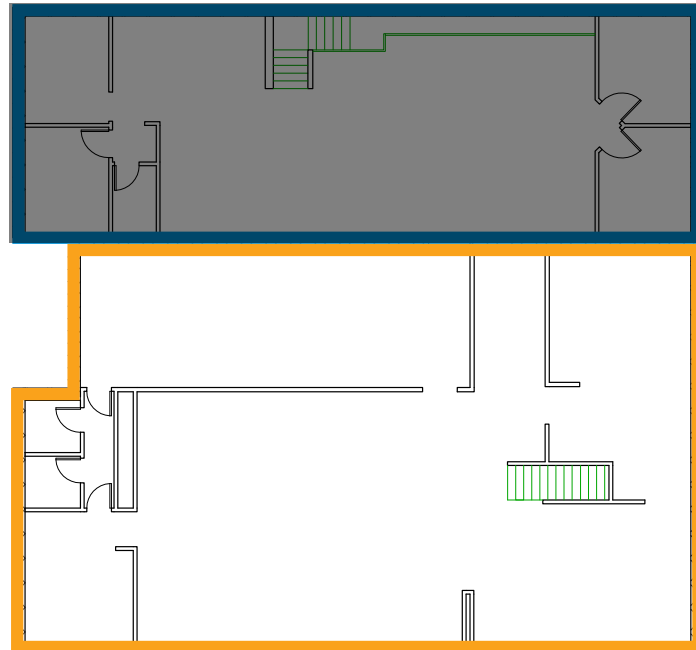

SECOND FLOOR

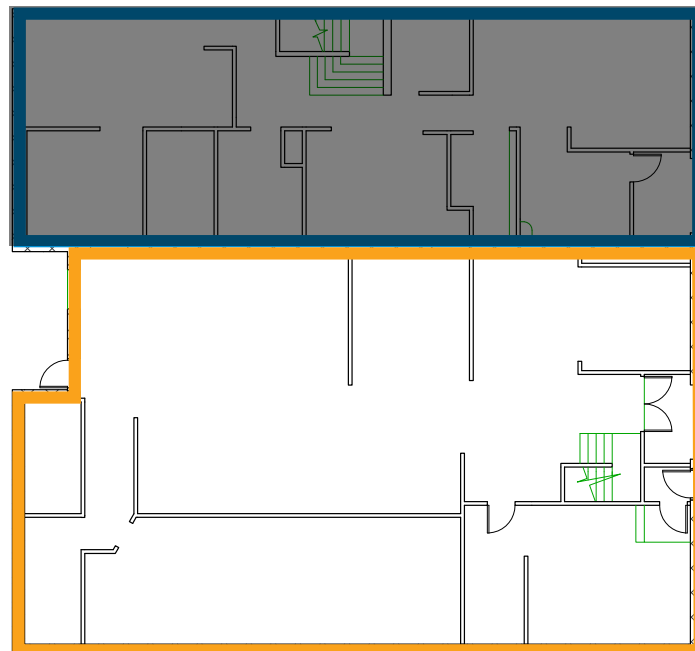

FOR MORE INFORMATION, PLEASE CONTACT

HANS HANSSON | 415.765.6897 | hans@starboardnet.com
LIC #00872902

CRAIG HANSSON | 415.694.5367 | craig@starboardnet.com
LIC #01841643

 **STARBOARD TCN**
WORLDWIDE COMMERCIAL REAL ESTATE
Local Focus, Global Reach

33 New Montgomery, Suite 1230
San Francisco, CA 94105
phone 415.765.6900 fax 415.956.2003
www.starboardnet.com